



EC000055

EG000020

NH knife fuse links with high breaking capacity used for electrical grids protection in short-circuit and overvoltage conditions



ELECTRICAL FEATURES

- ✓ Rated Voltage: 500-690 Vac. / 250 Vdc- 440 Vdc
- ✓ Rated Current: 6A – 1250A.
- ✓ Breaking Capacity: 120 kA (500 V) – 50 kA (690 V) / 100 kA (Vdc)
- ✓ Class: gG.

CONSTRUCTIVES FEATURES

- ✓ High resistance MgO ceramic body.
- ✓ High purity, chemically treated SiO₂ quartz sand used to extinguish the electrical arc.
- ✓ Electrolytic copper contacts with tin plate.
- ✓ Aluminum caps.
- ✓ Nickel and copper alloy fusing indicator.
- ✓ With double fusing indicator.



EN 60269-1:2007+A1
HD 60269-2:2010

REFERENCES

Reference	Code	Technical characteristics				
		Packaging	Vac	Vn	Breaking Capacity (AC)	Breaking Capacity (CC)
AC-000 16 A		3	500/690	440	120/50	100
AC-000 20 A		3	500/690	440	120/50	100
AC-000 25 A		3	500/690	440	120/50	100
AC-000 32 A		3	500/690	440	120/50	100
AC-000 40 A		3	500/690	440	120/50	100
AC-000 50 A		3	500/690	440	120/50	100
AC-000 63 A		3	500/690	440	120/50	100
AC-000 80 A		3	500/690	440	120/50	100
AC-000 100 A		3	500/690	440	120/50	100
AC-00 125 A	0104522	3	500/690	440	120/50	100
AC-00 160 A	0104524	3	500/690	440	120/50	100
AC-0 32 A		3	500/690	440	120/50	100
AC-0 40 A		3	500/690	440	120/50	100
AC-0 50 A		3	500/690	440	120/50	100
AC-0 63 A		3	500/690	440	120/50	100
AC-0 80 A		3	500/690	440	120/50	100
AC-0 100 A		3	500/690	440	120/50	100
AC-0 125 A		3	500/690	440	120/50	100
AC-0 160 A		3	500/690	440	120/50	100

REFERENCES

Reference	Code	Características técnicas				
		Packaging	Vac	Vn	Poder corte Alterna	Poder corte continua
AC-1 50 A	0104550	3	500/690	440	120/50	100
AC-1 63 A	0104552	3	500/690	440	120/50	100
AC-1 80 A	0104554	3	500/690	440	120/50	100
AC-1 100 A	0104556	3	500/690	440	120/50	100
AC-1 125 A	0104558	3	500/690	440	120/50	100
AC-1 160 A	0104560	3	500/690	440	120/50	100
AC-1 200 A	0104562	3	500/690	440	120/50	100
AC-1 250 A	0104564	3	500/690	440	120/50	100
AC-2 63 A		3	500/690	440	120/50	100
AC-2 80 A		3	500/690	440	120/50	100
AC-2 100 A		3	500/690	440	120/50	100
AC-2 125 A		3	500/690	440	120/50	100
AC-2 160 A	0104572	3	500/690	440	120/50	100
AC-2 200 A	0104574	3	500/690	440	120/50	100
AC-2 250 A	0104576	3	500/690	440	120/50	100
AC-2 315 A	0104578	3	500/690	440	120/50	100
AC-2 400 A	0104582	3	500/690	440	120/50	100
AC-3 250 A		3	500/690	440	120/50	100
AC-3 315 A		3	500/690	440	120/50	100
AC-3 400 A		3	500/690	440	120/50	100
AC-3 500 A		3	500/690	440	120/50	100
AC-3 630 A		3	500/690	440	120/50	100

DIMENSIONS (mm)

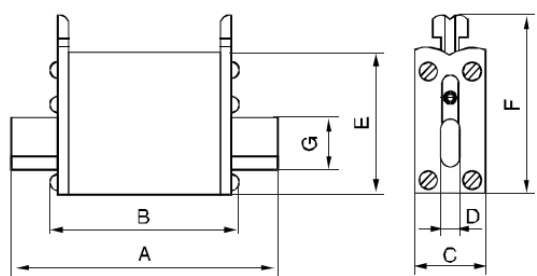

NH00C~NH00

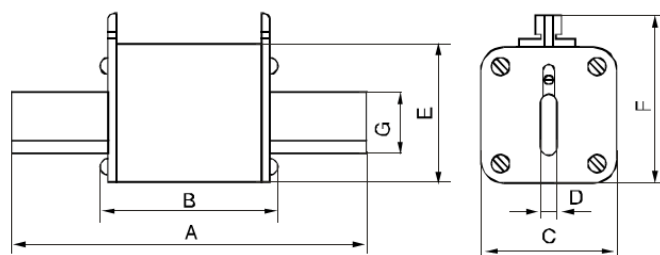

NH0~NH3

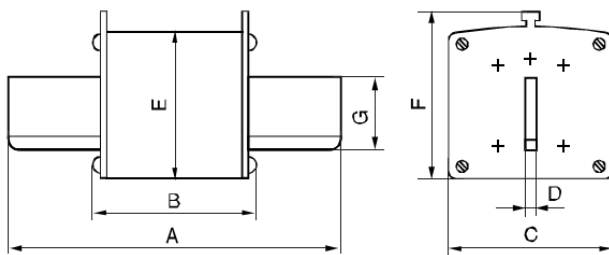

NH4

TYPE	A	B	C	D	E	F	G
NH-00	78.5	54.5	30	6	48	61	15
NH-0	125	68	30	6	48	61	15
NH-1	135	75	46	6	46	61	20
NH-2	150	75	58	6	58	73	25
NH-3	150	75	69	6	69	83	32
NH-4	200	97	100	6	100	112	50

TIME-CURRENT CHARACTERISTIC

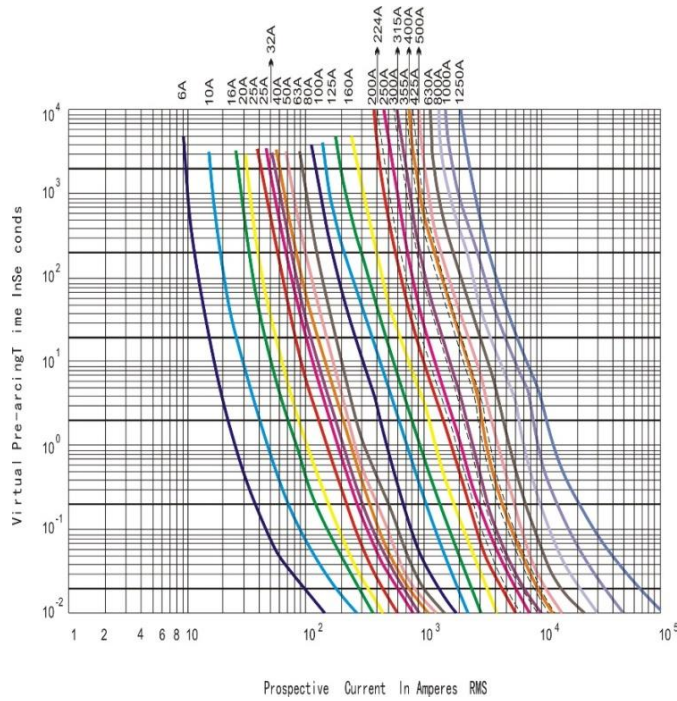

CURVE CUTTING CHARACTERISTICS

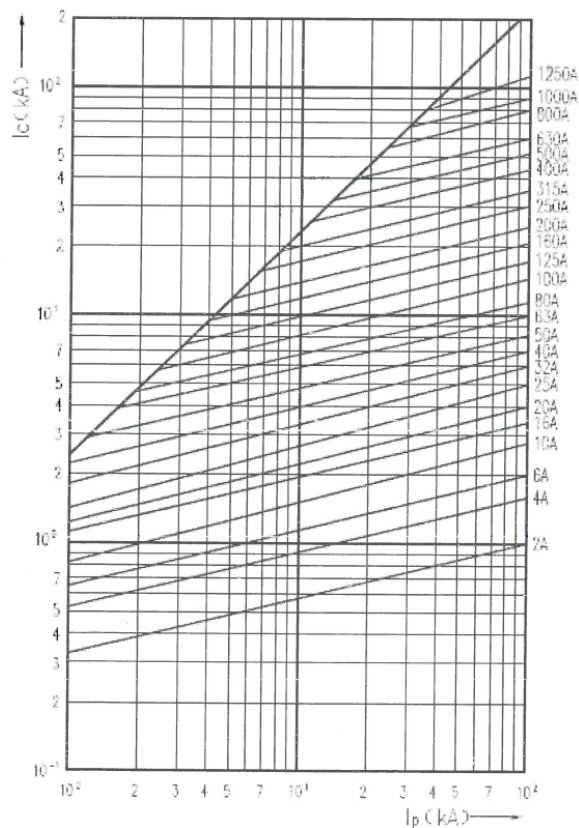

CURVE I2t

Typo	Rated voltage	Rated current	I ² t (kA ² S) Pre arch	I ² t (kA ² S) Fusion
NH00	500V	16A	0.307	1.06
		20A	0.691	1.8
		25A	1.08	3.7
		32A	1.92	7.8
		40A	3.13	14.1
		50A	6.25	17
		63A	14	25.4
		80A	25	47
		100A	39	72
		125A	48	132
		160A	98	204
NH1	500V	80A	22	50
		100A	34	85
		125A	50	145
		160A	101	233
		200A	175	332
		224A	232	471
		250A	310	582
NH2	500V	160A	105	225
		200A	150	355
		224A	150	355
		250A	215	650
		300A	335	1076
		315A	431	1289
		355A	658	1560
		400A	860	1710
NH3	500V	315A	467	1322
		355A	591	1652
		400A	804	1820
		425A	883	2170
		500A	1720	3345
		630A	3219	4900